



WORLD'S MOST
ADVANCED CAM SOFTWARE
FULLY INTEGRATED INSIDE SOLIDWORKS®

ACCELERATE YOUR MACHINING PRODUCTIVITY

Significantly reduce your programming time by as much as 90%



Program Smarter

With feature based machining, machinable part features are recognized automatically, virtually eliminating repetitive programming tasks



Machine Faster

Reduce machining time by as much as 85% and increase tool life by as much as 500% even in the hardest materials



Improve Customization & Setup Time

Capture and reuse your best programming practices, reducing programming time by as much as 80%

“ It’s virtually seamless. Within CAMWorks you have a roughing tab with a drop down menu. On the menu there are a number of different options you can choose. VoluMill is one of them. You pick VoluMill and put it to work for you. It’s that simple.

CAMWorks allowed us to get business we didn’t have before! ”

*Arlie Branham
Programmer, Tomak*

“ CAMWorks has been a huge part of our success in getting the NC code to the floor quickly and having the confidence in the offerings that we make. ”

*Neil Porter
Owner, NCAD*



WHY CAMWORKS

CAMWorks is the most advanced CAM system available today. Due to CAMWorks' superior technology, SOLIDWORKS selected CAMWorks to power its SOLIDWORKS® CAM. All of the data and post processors from SOLIDWORKS CAM are fully compatible with CAMWorks!

“ If you are designing in SOLIDWORKS and you want to start machining, get CAMWorks! ”

Lynn Bradbury
Mechanical Designer, Catrike

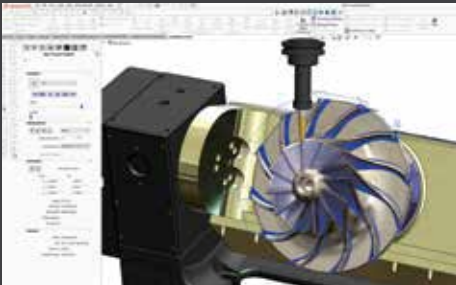

Program Inside Familiar SOLIDWORKS® Environment

- First and best integrated CAM software in SOLIDWORKS, powers SOLIDWORKS CAM
- Recognizes over 20 machinable features and creates fully associative features, operations and toolpaths automatically
- Toolpaths update instantly to design changes

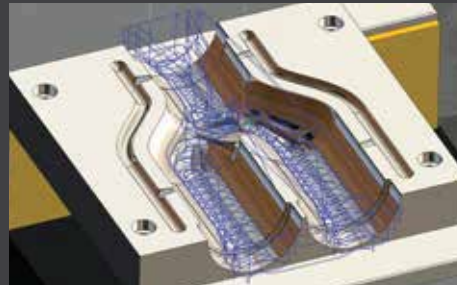

Faster Cycle Time with CAMWorks® VoluMill™

- CAMWorks VoluMill is an optional ultra high-performance toolpath engine within CAMWorks for 2.5 axis and 3 axis roughing operations.
- Reduce your cycle times by up to 80%
- Reduce your programming time up to 50%
- Increase your cutting tool life up to 500%

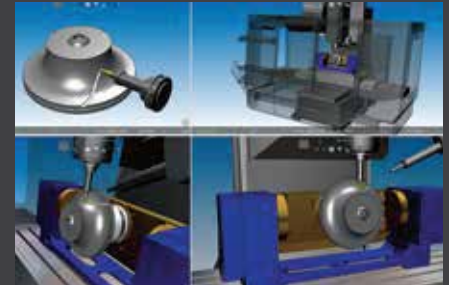

Cut Set-up Time with CAMWorks Virtual Machine

- Use CAMWorks Virtual Machine to virtually prove-out CNC programs and eliminate dry-runs on the machine. Cut setup times by 50% or more
- True G-code machine simulation
- Avoid collisions and broken tools

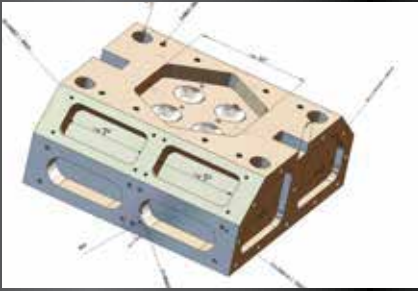

Tolerance Based Machining (TBM)

- Reads SOLIDWORKS Model Based Design (MBD) & Product Manufacturing Information (PMI)
- Automatically creates the toolpaths to meet the tolerance and surface finish requirements
- Supports GD&T and ISO 286 dimensioning

Improve Customization with Knowledge Based Machining

- Knowledge-based machining allows you to capture and reuse your best programming practices using the Technology Database, TechDB™, reducing programming time by as much as 80%

“ CAMWorks is very easy to install. The standard CAMWorks is easy, and the more advanced stuff like 5-axis machining is not too hard once you have an understanding of how the toolpathing works. In addition, the interface is clean and easy to understand. CAMWorks is always making improvements to their product and staying abreast of technology ”

*Mike Blake,
Program Manager, Magnus
Hi-tech*

COMPLETE POST PROCESSOR SUPPORT

We've teamed up with the industry's best to offer you the easiest and most comprehensive solutions possible



CAMWorks includes a Universal Post Generator (UPG) environment that enables users to modify existing posts or develop their own posts



Post processors for over 2000 machine tool and controller combinations will have you up and running in no time

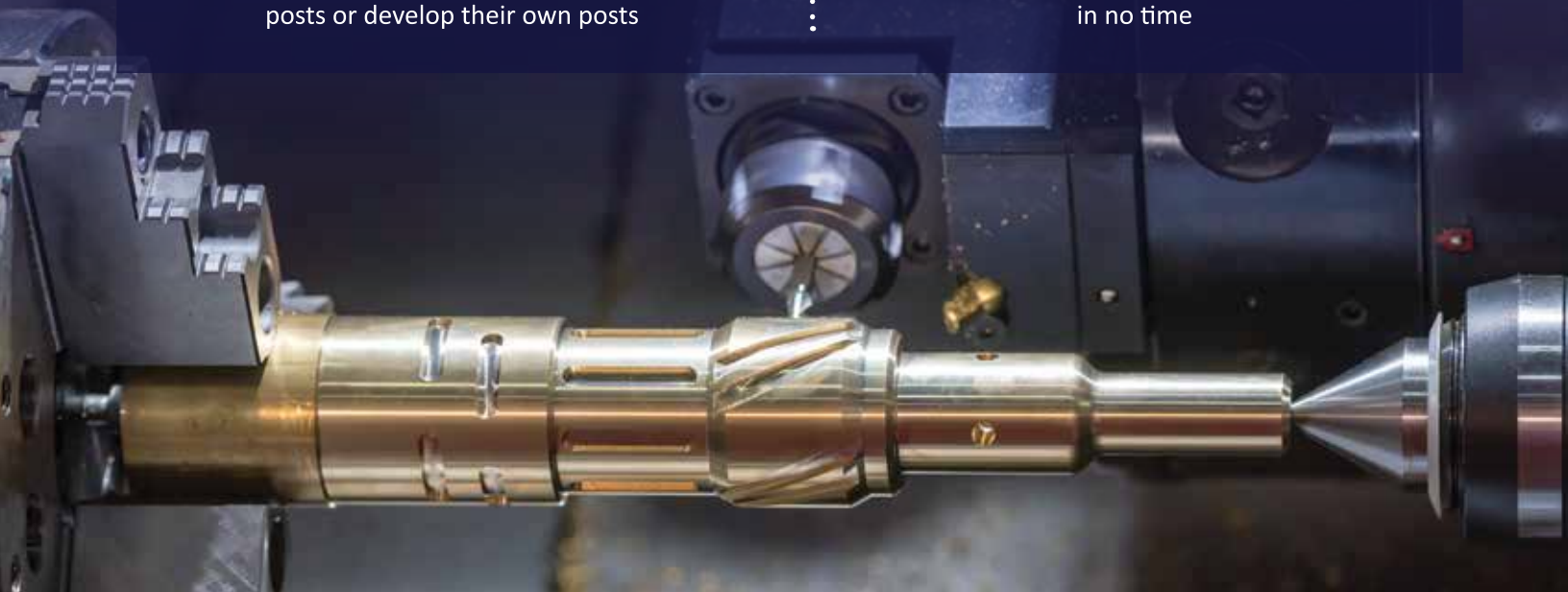

CAMWORKS SOLUTIONS FOR INTELLIGENT DIGITAL MANUFACTURING



CAMWorks Premium

CAMWorks Premium is the ultimate integrated CNC programming solution available for SOLIDWORKS. CAMWorks Premium combines advanced 3 axis milling, turning, and mill-turn capabilities along with superior 4 & 5 axis simultaneous milling into a single integrated easy to use system.



CAMWorks Milling Professional

CAMWorks Milling Professional is the most advanced 3 axis CNC programming solution available for SOLIDWORKS. It includes advanced 3 axis rough milling with rest machining and VoluMill for high speed machining. Finishing cycles including Z-level (waterline), flat area, pattern project, constant step-over, pencil milling, and curve project for engraving on 3D surface.



CAMWorks Turning Professional

CAMWorks Turning Professional includes advanced turning, mill-turn and C, Y & B axis capabilities, dual turret and sub-spindle support, and 2 & 4 axis turning with up to 11 axis mill-turn capabilities. CAMWorks Sync Manager for synchronous machining and CAMWorks Virtual Machine Standard for full machine simulation with collision detection are also included.



CAMWorks Standard

CAMWorks Standard is the perfect integrated CNC programming solution for SOLIDWORKS. CAMWorks Standard combines feature and knowledge based machining, with assembly machining, 4 & 5 axis indexing, advanced rotary milling, VoluMill for high speed machining, and full sub-spindle support for turning into a single easy to use integrated system.



CAMWorks Additive

CAMWorks Additive Manufacturing is the only hybrid (additive and subtractive) manufacturing system available for SOLIDWORKS. Automatically create support structures using the latest in additive technology from Materialise, a world leader in additive manufacturing. CAMWorks creates the machining operations to remove support structures and programs the machinable features automatically.

INTELLIGENT DIGITAL MANUFACTURING FOR SOLIDWORKS®

Automated Intelligent Programming



Programmer/
Machinist



Technology
Database
TechDB™



CNC Machine

Capture your best practices
.....
Store them in the TechDB™
.....
CAMWorks automatically uses them!



CAMWorks has helped us reduce time right from the product design stage to the delivery stage. The amount of reduction in time is more than 50% (of programming time), which is huge. Whenever we need to check if a part fits better on a sheet, we just have to move the part and CAMWorks recognizes it and instantaneously changes the code. This ability of interaction and easy code regeneration delivers efficiency and time savings.

CAMWorks is a great package and the perfect choice; it is a fast, modern software package that does exactly what we want!



*Vladan Zubcic
Manufacturing Manager, Sealegs*



Hello, I'm from HCL's Engineering and R&D Services. We enable technology led organizations to go to market with innovative products and solutions. We partner with our customers in building world class products and creating associated solution delivery ecosystems to help bring market leadership. We develop engineering products, solutions and platforms across Aerospace and Defense, Automotive, Consumer Electronics, Software, Online, Industrial Manufacturing, Medical Devices, Networking & Telecom, Office Automation, Semiconductor and Servers & Storage for our customers.

For more details contact: camworks.inquiries@hcl.com
Visit our website: <http://www.camworks.com>

Contact us

US: +1.480.367.0132

Europe: +49.172.7874221

APAC: +91.22.67056880